

Low Profile Series LOW

The LOW series hydraulic torque wrench is compact, flat and slim. The design makes it perfect for height-restricted applications. The torsion retaining pawl system achieves maximum efficiency as bolt torsion is restricted with each stroke, optimising direct preload force transmission.

- High resistance with aluminium-titanium and light body
- 700 bar maximum operation pressure
- Repeatability of $\pm 3,0\%$
- Torsion retaining ratchet system
- $360^\circ \times 180^\circ$ multi-positional swivel quick release couplings
- Interchangeable cassettes with small head radius
- Suitable for continuous operation at maximum pressure
- Pressure relief valve prevents over pressure

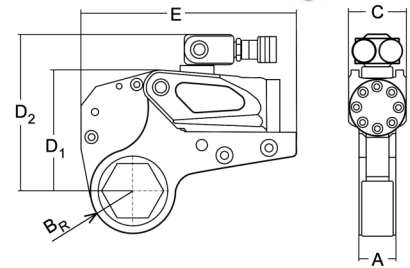

Type	Wrench size [mm]	Torque [Nm]		Weight [kg]	Dimensions [mm]					
		min.	max.		A	B _R	C	D ₁	D ₂	E
2 LOW	19-60	230	2.400	2,6	32	27-46	50	102	126	186
4 LOW	34-80	585	6.450	6,4	42	36-61	66	136	177	295
8 LOW	41-105	1.090	12.000	11,3	53	46-78	83	169	207	300
14 LOW	50-115	1.850	18.500	17,1	64	60-87	99	204	239	361
30 LOW	85-175	4.180	44.500	40,4	85	78-128	131	272	303	430

OPTIONS

- Higher torques on request
- Personalized engraving on the housing (for example: company logo)

ACCESSORIES

Screw coupling

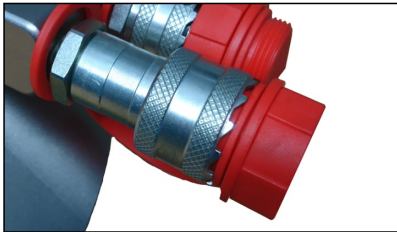

Damper support



Support extension

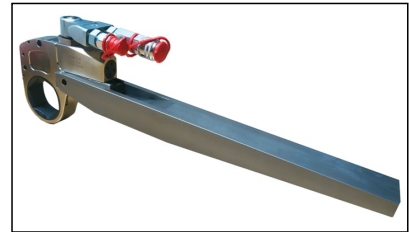

SCOPE OF DELIVERY

- Hydraulic torque wrench LOW
- Interchangeable cassette
- Torque table
- Calibration certificate
- Operation manual
- Tool case (to type 14 LOW)