

Electric Pump HEM 7 for Hydraulic Wrenches

The electric power pump HEM 7 was designed and developed by M-PT - made in Germany. With the new developed microprocessor-controlled automatic, the pump works in three stages even faster and more effective. An operation in manual mode is also possible.

- Three-stage hydraulic pump with electric drive for hydraulic torque wrenches
- Manual or automatic mode
- Extreme fast automatic function
- Continuous pressure setting
- Precision pressure gauge (1.000 bar - class 1,0)
- Incl. oil cooler for big pump (volume 8l)
- Handle und protection bracket made of steel
- High flow plug couplings
- For mains voltage 230 V, 50 Hz
- Documentation System optional
- ProTight™ worker guidance system optional

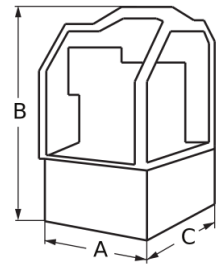

Type	Flow rate [l/min]	Pressure [bar]	Power [kW]	Volume [l]	Weight [kg]	Dimensions [mm]		
						A	B	C
HEM 7-037-3	High pressure: 0,3 Medium pressure: 1,0 Low pressure: 2,8	700	0,37	3	21,6	310	425	464
HEM 7-110-8	High pressure: 0,8 Medium pressure: 1,6 Low pressure: 7,0	700	1,1	8	29,2	302	445	482

OPTIONS

- Documentation System
- Remote control with digital pressure display
- Version as a 120 V machine
- Execution with pressure 800 bar
- Other cable lengths possible on request
- Special aggregate to customer requirements
- ProTight™ worker guidance system

ACCESSORIES

Oil cooler



Protective housing



Screw coupling



Point-to-multipoint connection



SCOPE OF DELIVERY

- Hydraulic pump HEM 7 with oil filling
- Operation manual